

# Application: CIG-0000000095

  
Community Impact Grant

## Summary

**ID:** CIG-0000000095

**Last submitted:** Mar 31 2025 02:22 PM (MDT)

**Labels:** Capital Grants, Arts & Culture

## Grant Application Form

Completed - Mar 31 2025

## Form for "Grant Application Form"

Please refer to the [Community Impact Grant Policy](#) and the [Greenview Support Recognition Policy](#) here.

## Organization Information

Name of Organization	Mountain Metis Community Association
Mailing Address	Box 1468
Town/City	Grande Cache
Postal Code	T0E 0Y0
Province	Alberta
Contact Name	[REDACTED]
Position of Contact Person	Executive Director
Email	[REDACTED]
Phone Number	[REDACTED]
Purpose of Organization	<p>The Mountain Métis Community Association serves historically connected descendants who previously resided in Jasper National Park in the 19th Century, as well as Métis who currently reside in Grande Cache. Our mission is to enhance the cultural, social and economic well-being of its community. We believe that each member of the community is valued, therefore a significant amount of time and effort has been provided to develop and manage special programs, economic opportunities, mentorship, and events that strengthen cultural continuity. Special regard is held towards Métis youth and Elders and in overcoming cultural barriers that limit the advancement of the people.</p>

**This is the act you are registered under.**

Please verify:

Societies Act

**Registration No.**

5125428432

---

**What type of Grant are you applying for?**

Capital Grant

---

**Total Amount Requested**

***\*Do not use commas when entering amount\****

\$ 1,000,000

---

## Proposed Project

The Mountain Métis Community Association is in the phase two of four, of constructing and build a new Mountain Métis Community Centre in Grande Cache, Alberta to contribute to preserving and sharing the Mountain Métis culture, fostering inclusivity, and promoting tourism and economic growth in Grande Cache and surrounding areas.

The build includes:

**Métis Cultural & Interpretive Centre:** The new facility will feature a Métis Cultural & Interpretive Centre that will allow for the sharing of the unique history, traditions, and culture of the Canadian Rockies. With the potential to attract annual visitors. The center will raise awareness and provide an opportunity for the general public to learn more about the Mountain Métis culture and history. This Community center will contribute to the region's overall tourism economy and provide additional activities for all residents and visitors.

**Community Hall:** The project also includes the construction of a new community hall in Grande Cache. This additional rental space for community functions and events will support and increase economic activity in the hamlet by providing a large space to residents and visitors who are expected to benefit from the new community hall each year, contributing to local community development. The community hall will provide a central, public space for community members to gather for various activities, social connections, events, and information, serving as hub for learning, and cultural exchange.

The new Mountain Métis community building in Grande Cache is expected to bring economic value in several keyways:

**Job Creation and Local Employment;** once operational, it will create more jobs for administrative staff, program coordinators, maintenance personnel, and cultural workers.

**Tourism and Cultural Promotion;** the building will serve as a hub for Métis culture, history, and art, attracting tourists interested in Indigenous experiences. It will host cultural events, workshops, and exhibits, bringing in visitors and increasing local spending on hotels, restaurants, and shops.

**Business and Entrepreneurship Opportunities;** local Métis artisans and craftspeople will have a space to sell traditional goods, such as beadwork, moccasins, and carvings. The facility will offer spaces for Métis-led businesses.

**Community and Social Services Impact;** the building provides educational/mentorship programs, traditional land use, and support services, it can help Métis and non-Métis residents improve their skills and employability. Social initiatives like, elder support, and mentorship programs will enhance workforce participation.

**Event Hosting and Rentals;** the facility will generate revenue by hosting weddings, conferences, meetings, and community events, attracting visitors from surrounding areas.

Strengthening Regional Partnerships; collaborations with local businesses, tourism operators, and government organizations will drive economic initiatives benefiting the whole region.

**Have you previously applied for a grant from the MD of Greenview?**

Yes

**Was your previous grant application successful?**

Yes

**Year Grant Received**

2024

**Amount of Grant**

***\*Do not use commas when entering amount\****

\$ 47500

**Grant Purpose**

Operating grant for the Youth Connection's program and annual summer youth camp.

**Have you provided the MD of Greenview with a final completion report for grant funds received?**

Yes

Have you applied for grant funds from sources other than the MD of Greenview?

Yes

List the donor, purpose and amount

	Donor	Purpose	Amount (\$)
1	Please see attached Building Donations	Donations to the new Mountain Metis Community Association Community Center Building Fund	1828217
2			
3			
4			
5			
Total			1828217.0

Have you performed any other fundraising projects?

Yes

**What type of fundraising and how much did you raise?**

Fundraising Type Examples: Bottle drive, Bake sale, etc

	Fundraising Type	Funds Raised
1	Online Draw 1	670
2	Online Draw 2	840
3		
4		
5		
Total		1510.0

**If awarded, please list how you plan to recognize the MD of Greenview.**

i.e. Social Media, Posters, Signs, Website

Public Acknowledgment – We will acknowledge the MD of Greenview in press releases, social media posts, and our website, highlighting their generous support.

**Greenview Logo Permission Requirements**

Please contact the Communications Department at [communications@mdgreenview.ab.ca](mailto:communications@mdgreenview.ab.ca) for all use of Greenview Logos as well as advertising, signs and imaging which require authorization by Greenview communications team.

**FOIP Disclosure**

Any personal information that the Municipal District of Greenview may collect on this form is in compliance with Section 33(a) and 39(1)(a)(b)(c) of the Freedom of Information and Protection of Privacy Act. The information collected is required for the purpose of carrying out an operating program or activity of the Municipality, in particular for the purpose of the Community Impact Grant. If you have any questions about the collection please contact the Freedom of Information and Protection of Privacy Coordinator at 780.524.7600.

By signing and typing your name below the signature line below you are confirming you have provided the required information for the grant application.

*Please use your mouse to sign*



Name:



Date:

Mar 31 2025

## Upload past financial statements

**Completed** - Mar 31 2025

If you do not have a financial statement to upload, please complete the "Profit Loss Statement" and "Balance Sheet" form templates provided.

### [Balance Sheet](#)

**Filename:** Balance\_Sheet.pdf **Size:** 546.8 kB

### [Income Statement](#)

**Filename:** Income\_Statement.pdf **Size:** 550.8 kB

## Budget for current year/current project

**Completed** - Apr 24 2025

### [Building Budget](#)

**Filename:** Building\_Budget.pdf **Size:** 555.9 kB

### [Funding Plan](#)

**Filename:** Funding\_Plan.pdf **Size:** 141.0 kB



## [Budget](#)

Filename: Budget.pdf Size: 92.7 kB

## **Any supporting documents, ie. Quotes, etc.**

Completed - May 6 2025

## [Building 1](#)



Filename: Building\_1.png Size: 16.5 MB

## [Building 3](#)



Filename: Building\_3.png Size: 14.0 MB

## [Building 4](#)



Filename: Building\_4.png Size: 16.5 MB

[Building 2](#)



Filename: Building\_2.png Size: 16.4 MB

[Image 2024-07-19 at 8](#)



Filename: Image\_2024-07-19\_at\_8.59AM.jpeg Size: 672.2 kB

[Vic Stapleton](#)

Filename: Vic\_Stapleton.pdf Size: 40.0 kB

[Willmore Wilderness](#)

Filename: Willmore\_Wilderness.pdf Size: 880.3 kB

## [Chamber of Commerce](#)

**Filename:** Chamber\_of\_Commerce.pdf **Size:** 699.6 kB

## [Mountain Metis Building & Seating](#)

**Filename:** Mountain\_Metis\_Building\_\_Seating.pdf **Size:** 255.2 kB

# Mountain Metis Community Association

## Balance Sheet As at 2024-12-31

### ASSET

#### Current Assets

Cash to be deposited	0.00	
Cash Draws	0.00	
Petty Cash	1,936.11	
ATB (Youth Con 878)	89,151.68	
ATB (Hide Away 278)	8,718.85	
ATB (General 178)	135,308.33	
Servus MMCA	4,911.39	
GIC #1	21,000.00	
ATB Building Bridges	39,700.98	
Foreign Currency Bank	0.00	
Total Cash		300,727.34
Visa Receivable	0.00	
MasterCard Receivable	0.00	
American Express Receivable	0.00	
Other Credit Card Receivable	0.00	
Online Payment Receivable	0.00	
Total Payment Receivables		0.00
Investments		0.00
Accounts Receivable	2,000.00	
Allowance for Doubtful Accounts	0.00	
Advances & Loans	0.00	
Total Receivable		2,000.00
Purchase Prepayments		0.00
Uninvoiced Goods & Services		0.00
Prepaid Expenses		0.00
Total Current Assets		302,727.34

#### Inventory Assets

Inventory A	0.00
Inventory B	0.00
Inventory C	0.00
Total Inventory Assets	0.00

#### Capital Assets

Leasehold Improvements	0.00
Office Furniture & Equipment	180.00
Accum. Amort. -Furn. & Equip.	0.00
Net - Furniture & Equipment	180.00
Vehicle	0.00
Accum. Amort. -Vehicle	0.00
Net - Vehicle	0.00
Building	0.00
Accum. Amort. -Building	0.00
Net - Building	0.00
Land	0.00
Total Capital Assets	180.00

#### Other Non-Current Assets

Computer Software	0.00
Goodwill	0.00
Incorporation Cost	0.00
Total Other Non-Current Assets	0.00

**TOTAL ASSET** 302,907.34

### LIABILITY

#### Current Liabilities

Accounts Payable	3,659.88
------------------	----------

Printed On: 2025-03-31

# Mountain Metis Community Association

## Balance Sheet As at 2024-12-31

Import Duty Clearing		0.00
Bank Loan - Current Portion		0.00
Bank Advances		0.00
Diane Mastercard	0.00	
MasterCard Payable	-2,667.75	
Marissa Mastercard	1,091.16	
Lisa Mastercard	0.00	
Total Credit Card Payables		-1,576.59
Corporate Taxes payable		0.00
Vacation payable		5,788.97
EI Payable	414.49	
CPP Payable	1,156.82	
Federal Income Tax Payable	1,322.43	
Total Receiver General		2,893.74
WCB Payable		0.00
User-Defined Expense 1 Payable		0.00
User-Defined Expense 2 Payable		0.00
User-Defined Expense 3 Payable		0.00
User-Defined Expense 4 Payable		0.00
User-Defined Expense 5 Payable		0.00
Deduction 1 Payable		2,313.79
Deduction 2 Payable		0.00
Deduction 3 Payable		0.00
Deduction 4 Payable		0.00
Deduction 5 Payable		0.00
GST/HST Charged on Sales	0.00	
GST/HST Charged on Sales - R...	0.00	
GST/HST Paid on Purchases	-10,377.88	
GST/HST Payroll Deductions	0.00	
GST/HST Adjustments	0.00	
ITC Adjustments	0.00	
GST/HST Owing (Refund)		-10,377.88
Prepaid Sales/Deposits		0.00
Goods Received - Not Invoiced		0.00
<b>Total Current Liabilities</b>		<b>2,701.91</b>
<b>Long Term Liabilities</b>		
Bank Loans		0.00
Mortgage Payable		0.00
Loans from Owners		0.00
<b>Total Long Term Liabilities</b>		<b>0.00</b>
<b>TOTAL LIABILITY</b>		<b>2,701.91</b>
<b>EQUITY</b>		
<b>Owners Equity</b>		
Owners Contribution		0.00
Owners Withdrawals		0.00
Retained Earnings - Previous Year		358,077.07
Current Earnings		-57,871.64
<b>Total Owners Equity</b>		<b>300,205.43</b>
<b>TOTAL EQUITY</b>		<b>300,205.43</b>
<b>LIABILITIES AND EQUITY</b>		<b>302,907.34</b>



# Mountain Metis Community Association

## Income Statement 2024-01-01 to 2024-12-31

### REVENUE

<b>Sales Revenue</b>	
Sales Inventory A	0.00
Sales Inventory B	0.00
Sales Inventory C	0.00
Telephone Donations	0.00
Door-to-door Donations	0.00
Operating Revenue	0.00
MMCA Youth	203,773.00
MMCA Hideaway	46,100.00
Building Bridges Grant	100,000.00
MMCA	657,222.79
Early Payment Sales Discounts	0.00
<b>Net Sales</b>	<u>1,007,095.79</u>
<b>Other Revenue</b>	
Freight Revenue	0.00
Gain/Loss when Invoiced: DO	0.00
Gain/Loss when Invoiced: GRN	0.00
Interest Revenue	230.17
Community Donation	-87,500.00
Miscellaneous Revenue	0.07
<b>Total Other Revenue</b>	<u>-87,269.76</u>
<b>TOTAL REVENUE</b>	<u>919,826.03</u>

### EXPENSE

<b>Cost of Goods Sold</b>	
Inventory A Cost	0.00
Inventory B Cost	0.00
Inventory C Cost	0.00
Inventory Variance	0.00
Item Assembly Costs	0.00
Adjustment Write-off	0.00
Transfer Costs	0.00
Subcontracts	0.00
Purchases	0.00
Purchase Returns	0.00
Early Payment Purchase Discou...	0.00
Net Purchases	0.00
Freight Expense	0.00
<b>Total Cost of Goods Sold</b>	<u>0.00</u>
<b>Payroll Expenses</b>	
Wages & Salaries	350,056.50
EI Expense	7,847.85
CPP Expense	18,793.06
WCB Expense	2,420.81
User-Defined Expense 1 Expense	0.00
User-Defined Expense 2 Expense	0.00
User-Defined Expense 3 Expense	0.00
User-Defined Expense 4 Expense	0.00
User-Defined Expense 5 Expense	0.00
Employee Benefits	11,015.65
<b>Total Payroll Expense</b>	<u>390,133.87</u>
<b>General &amp; Administrative Expe...</b>	
Accounting & Legal	4,582.42
Professional fees	91,946.29
Advertising & Promotions	1,620.21
Bad Debts	-2,200.00

# Mountain Metis Community Association

## Income Statement 2024-01-01 to 2024-12-31

Business Fees & Licenses	9,219.19	
Cash Short/Over	0.00	
Courier & Postage	358.59	
Credit Card Charges	9,034.15	
Currency Exchange & Rounding	0.00	
Amortization Expense	0.00	
Income Taxes	0.00	
Insurance	30,480.00	
Interest & Bank Charges	443.60	
Office Supplies	23,518.76	
Janitorial	3,060.75	
Property Taxes	787.70	
Motor Vehicle Expenses	4,601.18	
Repairs and Maintenance HAWC	5,258.82	
Travel Expense (KM)	24,370.24	
Job Training	11,983.05	
Miscellaneous Expenses	136.48	
Fuel	7,462.81	
Realized Exchange Gain/Loss	0.00	
Rent	66,034.17	
Snow Removal	1,290.00	
Repair & Maintenance	121.76	
Donation	1,700.00	
Field Supplies	20,716.66	
TCEI	296.39	
Aquatics	0.00	
Telephone/Internet	12,432.69	
Hide A Way Camp	6,501.59	
Youth Connection	15,537.40	
Honorarium	103,047.00	
Travel /Food/ Entertainment/Lod...	107,653.53	
Building Bridges	9,890.03	
Building Expense	281.39	
Mountain Metis Cultural Associat...	0.00	
Community Engagement	0.00	
Travel & Ent:Non-Reimbursable	0.00	
Utilities	15,396.95	
Visa Commissions	0.00	
MasterCard Commissions	0.00	
American Express Commissions	0.00	
Other Credit Card Commissions	0.00	
Online Payment Fees	0.00	
Total Payment Processing Fees	0.00	
<b>Total General &amp; Admin. Expen...</b>	<b>587,563.80</b>	
<b>TOTAL EXPENSE</b>	<b>977,697.67</b>	
<b>NET INCOME</b>	<b>-57,871.64</b>	

		DRAFT BASELINE BUDGET June, 2024		BUDGET RATIONALE
ID	DESCRIPTION			
5.00	CONSTRUCTION DIRECT COST			
5.01	Building Construction	\$	9,975,000	As per Fillmore Construction
5.02	Site Construction	\$	-	Included in above
5.03	Off-Site Communications	\$	15,000	Placeholder
5.04	Targetted Cost Savings			To be discussed
5.05a	Assumed MMCA donation - Lumber			Included in above
5.05b	Assumed MMCA donation - Gravel			As per assumed info from McNeil Construction via contractors info
5.05c	Assumed MMCA donation - Other (materials, labour, etc.)			Plug
Construction Direct Cost Sub-Total		\$	9,990,000	
TOTAL - PROJECT HARD COST		\$	9,990,000	

CONTINGENCY / ALLOWANCES				
7.00	CONTINGENCY			
7.01	Soft Cost Contingency	\$	100,000	Approx 10% of Soft Costs now NOT including land
7.02	Construction Contingency	\$	500,000	Approx 5% of Hard Cost
Contingency Sub-Total		\$	600,000	
8	ALLOWANCES			
8.01	Inflation Allowance			Inflation already allowed for in above numbers for 2023 construction start only
Allowances Sub-Total				
TOTAL - CONTINGENCY / ALLOWANCES		\$	600,000	

TOTAL PROJECT COST				
Budget		\$	11,724,000	
If Inclusive of GST - not including land		\$	12,289,000	MMCA to review GST Rebates

EXCLUSIONS				
E.01	Interest			NIC
E.02	GST			
E.03	Tax credits			
E.05	Loss of Revenue			
E.06	Major schedule delays			
E.07	Other major levies, improvements, etc			
E.08	LEED, Solar, other green initiatives			
E.09	Moving Costs			
E.10	Other cost savings			
E.11	Other Losses			
E.12	Grant Pursuits			
E.13	Internal Costs			





## Mountain Métis Community Association

PO Box 1468  
Grande Cache, AB T0E 0Y0  
780-827-2002

### Mountain Métis Community Association Community Centre Funding Plan

#### 1. Executive Summary

The Mountain Métis Community Association (MMCA) seeks to establish a Community Centre to serve as a cultural, educational, and social hub for Métis and Community people in the region. The Centre will promote Métis heritage, provide vital programs and services, and foster community connection. The funding plan outlines a multi-phase, multi-source approach to secure approximately **\$10.59 million** for construction direct costs of the Community Centre.

#### 2. Funding Goal Breakdown

Category	Estimated Cost	Rationale
Building Construction	\$9,990,000	As per Fillmore Construction
Contingency (10% Soft Costs + 5% Hard Costs)	\$600,000	
<b>Total Funding Needed</b>	<b>\$10,590 million</b>	

#### 3. Funding Sources

##### A. Government Grants (Federal, Provincial, Municipal) – \$5,000,000+

###### 1. Federal

- GOA- Community Facility Enhancement Program-Large (CFEP) – Community Infrastructure Program
- Infrastructure Canada – Green and Inclusive Community Buildings

###### 2. Provincial (Alberta)

- GOA – Community Facility Enhancement Program-Small (CFEP)

###### 3. Municipal

- Local municipal matching grants
- Community revitalization funding

### C. Private Donations, Grants and Corporate Sponsorship – \$4,000,000+

- Local Métis-owned businesses
- Regional industry sponsors (e.g., oil & gas, forestry, tourism)
- Corporate Social Responsibility programs (e.g., Enbridge, Suncor, Telus)
- Donor recognition program with naming rights (rooms, halls, plaques)

### D. Foundations and Nonprofit Grants – \$250,000+

- Trillium Foundation
- McConnell Foundation
- Calgary Foundation / Edmonton Community Foundation
- Indigenous-focused philanthropic grants (e.g., Inspire Canada, Circle on Philanthropy)

### E. Community Fundraising – \$250,000

- Local fundraising events: raffles and galas
- Volunteer-driven initiatives

## 4. Phased Funding Strategy

Phase	Activities	Timeline	Funding Needed	Sources
Phase 1	Feasibility, Land, Design	6–12 months	\$424,000	Corporate
Phase 2	Construction, Equipment	12–24 months	\$3.4 million	Corporate & private
Phase 3	Construction & Operations	Ongoing	\$6,642,702 million	Government grants & Donations

## 5. Sustainability Plan

- **Program Revenue:** Event rentals, workshops, cultural classes, language programs
- **Membership Fees:** Nominal fees for individuals and families
- **Annual Grant Applications:** Operating grants, cultural programming
- **Social Enterprise:** Gift shop, Métis art sales
- **Partnerships:** Schools, colleges, other Indigenous orgs

## 6. Risk Mitigation

Risk	Mitigation Strategy
Grant rejection/delay	Apply to multiple streams, have phased buildout
Construction cost overrun	Include 10–15% contingency, fixed-price contracts
Donor fatigue	Stagger campaigns, rotate themes, engage youth
Operational shortfall	Diversify revenue, annual reviews, strong board

## **7. Key Next Steps**

1. Identify and prioritize grant applications
2. Launch fundraising committee
3. Social media campaigns

## Mountain Metis Community Centre Budget

<b>Income <i>with</i> Grants</b>	<b>Amount (\$)</b>	
Donations	\$3,347,297.89	
GIC's	\$1,200,000.00	
Grants	\$4,000,000.00	Note: Grant applications have gone out and waiting to hear back on decisions
<b>Total Income</b>	<b>\$8,547,297.89</b>	

<b>Income without Grants</b>	<b>Amount (\$)</b>
Donations	\$3,347,297.89
GIC's	\$1,200,000.00
<b>Total Income</b>	<b>\$4,547,297.89</b>

<b>Expense</b>	<b>Amount (\$)</b>
Construction	\$2,740,158.90
Land Purchase	\$424,000.00
General & Administrative	\$34,506.78
<b>Total Expenses</b>	<b>\$3,198,665.68</b>

**Estimated Cost to Build Community Centre: 10, 590,000.00 + GST 529,500.00 = 11,119.500**

<b>Revenue Raised</b>	<b>With Grants</b>	<b>Without Grants</b>
<b>Cost to Build Centre</b>	\$11,119,500.00	\$11,119,500.00
<b>Income</b>	\$8,547,297.89	\$4,547,297.89
<b>Expenses</b>	\$3,198,665.68	\$3,198,665.68
<b>Income necessary to finish building</b>	\$2,572,202.11	\$6,572,202.11

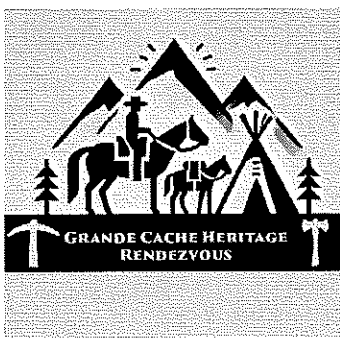

Box 1342  
Grande Cache, Alberta  
T0E 0Y0

**Date: Friday 29<sup>th</sup> March 2025**

From: Grande Cache Heritage Rendezvous Committee  
Vic Stapleton Chairperson

**Re: Letter of Support**

To Whom It May Concern:

I am providing this Letter of Support for the Mountain Metis Community Association in their request for funding to complete the New Mountain Metis Community Center. For years Grande Cache has needed a community hall that provides the capacity and infrastructure to host both large and small community events. The Mountain Metis Community Centre will fulfill this need and connect many community agencies to provide a variety of cultural, social, and recreation programs for our Hamlet. By providing funding you will assist Grande Cache in the achievement of this worthwhile goal, thus, strengthening our community and its people.

Yours truly,

Logan Leonard, Co-Chairman  
Heritage Rendezvous Committee

c.c. File



# *willmore wilderness foundation*

## **Willmore Wilderness Foundation**

Box 93

Grande Cache, AB, T0E 0Y0

[info@willmorewilderness.com](mailto:info@willmorewilderness.com)

780-827-2696

March 27, 2025

Mountain Métis Community Association

Box 1468

Grande Cache, AB

[marissa@mmetis.org](mailto:marissa@mmetis.org)

780-827-2002

## **Subject: Letter of Support for the Mountain Métis Community Centre**

Dear Municipal District of Greenview No. 16

On behalf of the Willmore Wilderness Foundation, we are pleased to express our full support for the Mountain Métis Community Association's initiative to establish the new Mountain Métis Community Centre in Grande Cache. This project represents a vital step forward in strengthening the cultural, historical, and social fabric of the region and will serve as a beacon for Métis heritage and traditions.

The Willmore Wilderness Foundation recognizes the invaluable contributions of the Mountain Métis people to the history, land stewardship, and cultural identity of the region. Your community's deep connection to the land, traditions, and knowledge aligns closely with our mission to preserve and promote the natural and cultural heritage of the Willmore Wilderness area.

The establishment of the Mountain Métis Community Centre will provide a much-needed space for cultural events, educational programs, community gatherings, film festivals and the preservation of traditional knowledge. It will also serve as a hub for intergenerational learning, fostering a deeper understanding and appreciation of the Métis way of life among youth and the broader community. Furthermore, it will strengthen partnerships between Indigenous and non-Indigenous organizations, creating opportunities for collaboration on environmental conservation, cultural education, and sustainable land management.

*stewards of willmore wilderness park*

Box 93 | 4600 Pine Plaza | Grande Cache, Alberta T0E 0Y0 | tel: 780-827-2696 fax: 780-827-4799

[info@willmorewilderness.com](mailto:info@willmorewilderness.com) | [www.WillmoreWilderness.com](http://www.WillmoreWilderness.com) | [www.PeopleandPeaks.com](http://www.PeopleandPeaks.com)





We strongly support this initiative and encourage funding agencies, governmental bodies, and other stakeholders to recognize the immense value this community centre will bring to the people of Grande Cache and beyond. The Willmore Wilderness Foundation stands ready to collaborate and support the Mountain Métis Community Association in this endeavor, ensuring that Métis heritage and traditions continue to thrive for generations to come.

Please do not hesitate to reach out if there are any ways in which we can further support this meaningful project. We look forward to witnessing the successful development of the Mountain Métis Community Centre and celebrating its positive impact on the region.

Sincerely,



Susan Feddema-Leonard  
Executive Director  
Willmore Wilderness Foundation



Box 1342  
Grande Cache, Alberta  
T0E 0Y0

Mountain Métis Community Association  
Box 1468, Grande Cache, AB, T0E 0Y0  
[marissa@mmetis.org](mailto:marissa@mmetis.org)  
780-827-2002

Dear Municipal District of Greenview No. 16,

On behalf of the Grande Cache Chamber of Commerce, I am pleased to provide this letter of support for the Mountain Metis Community Association (MMCA) in their application for funding to assist in the construction of the new Mountain Metis Community Center. This initiative represents a significant and much-needed investment in the economic and social development of our region. This project is a significant step forward in fostering economic growth, cultural enrichment, and community engagement within our region.

The new Mountain Métis Community Centre will not only serve as a gathering place for local residents but will also attract visitors and tourists who are eager to learn about the rich Métis heritage and traditions. By creating a dedicated space that showcases the history, arts, and customs of the Mountain Métis people, this centre will enhance Grande Cache's tourism sector and bring increased economic opportunities to local businesses and entrepreneurs.

In addition to its cultural significance, the community centre will provide an essential space for events, educational programs, and business development initiatives that will benefit the entire region. By fostering collaboration and entrepreneurship, this initiative will help strengthen our local economy, create jobs, and contribute to the overall well-being of Grande Cache.

The Grande Cache Chamber of Commerce fully supports the Mountain Métis Community Association in this endeavor that will provide direct and indirect benefits to Greenview residents and surrounding communities in recognizing the immense value this project will bring to our community.

Sincerely,

A handwritten signature in black ink, appearing to read "Wally McNeil", written over a horizontal line.

Wally McNeil  
President  
Grande Cache Chamber of Commerce





## **Mountain Métis Community Association**

PO Box 1468  
Grande Cache, AB T0E 0Y0  
780-827-2002

April 23, 2025

### **Municipal District of Greenview No. 16**

4806 – 36 Avenue  
PO Box 1079  
Valleyview, AB T0H 3N0

### **Subject: Follow-up to April 15, 2025, Council Meeting – Financial Breakdown**

Dear Reeve Olsen and Members of Council,

On behalf of the Mountain Métis Community Association, I extend our sincere thanks for the opportunity to meet with you on April 15, 2025. As requested by Reeve Olsen and Council, please find attached a Project budget, funding plan, and seating capacity to date for our ongoing community development project.

### **Community Donations and Funding Received**

Thanks to the overwhelming generosity and commitment of our supporters, we have raised **\$3,347,297.89** to date. A record of contributions shows the generosity and commitment from community members, organizations, and Industry in contributing financial backing that clearly demonstrates the shared vision and unified effort within our community to bring this meaningful project to life.

This financial support reflects the strong community commitment and shared vision for the development of this project. We are pleased to report the significant progress made in securing some of the funding and look forward to continued collaboration with the Municipal District of Greenview No.16.

Following is the plans for The Great Hall as projected will seat up to 192 people. We have considered this could change once the fire department ensures compliance with fire safety regulations and seating capacity.

## The Great Hall

The Great Hall will be 241 m<sup>2</sup> or 2594 sq. ft. It can seat up to 192 people.

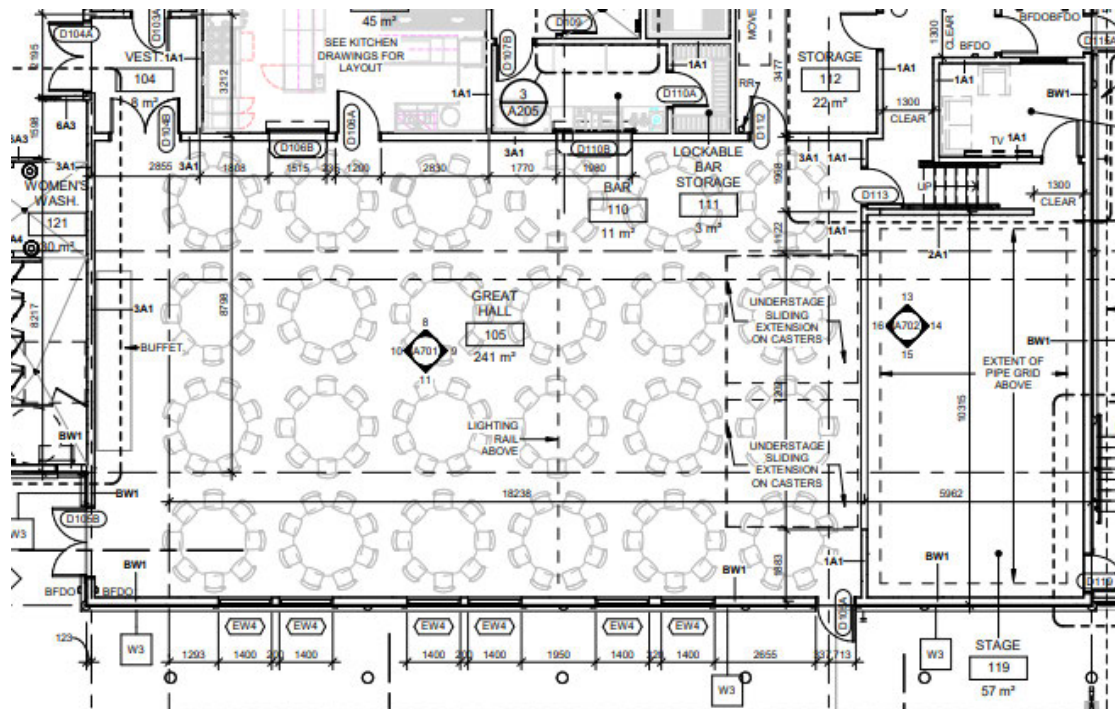

Should you require any additional documentation or clarification, please do not hesitate to contact me at your convenience. We appreciate your continued support and consideration.

With Appreciation,

Marissa Fearnside, BCom  
Executive Director  
Mountain Metis Community Association  
Office: 780-827-2002  
Box 1468, Grande Cache, AB, T0E0Y0  
Website: [mountainmetis.com](http://mountainmetis.com)